

FAG

**62202-A-2RSR**

Deep groove ball bearing

Schaeffler ID:  
0596148380000Deep groove ball bearing 622..-A-2RSR,  
single row, steel sheet metal cage

## Technical information

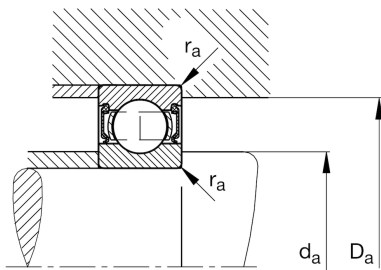
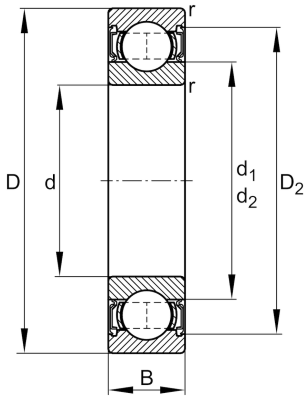
**Dimensions**

|            |          |                              |
|------------|----------|------------------------------|
| $r_{\min}$ | 0.6 mm   | Minimum chamfer dimension    |
| $D_2$      | 30.6 mm  | Caliber diameter outer ring  |
| $d_1$      | 21.1 mm  | Shoulder diameter inner ring |
|            | 0.056 kg | Weight                       |

**Main Dimensions & Performance Data**

|          |              |                                   |
|----------|--------------|-----------------------------------|
| $d$      | 15 mm        | Bore diameter                     |
| $D$      | 35 mm        | Outside diameter                  |
| $B$      | 14 mm        | Width                             |
| $C_r$    | 7,730 N      | Basic dynamic load rating, radial |
| $C_{0r}$ | 3,760 N      | Basic static load rating, radial  |
| $C_{ur}$ | 220 N        | Fatigue load limit, radial        |
| $n_G$    | 12,700 1/min | Limiting speed                    |

**Mounting dimensions**

|             |         |                                      |
|-------------|---------|--------------------------------------|
| $d_{a\min}$ | 19.2 mm | Minimum diameter shaft shoulder      |
| $D_{a\max}$ | 30.8 mm | Maximum diameter of housing shoulder |
| $r_{a\max}$ | 0.6 mm  | Maximum fillet radius                |

**Calculation factors**

|       |      |                    |
|-------|------|--------------------|
| $f_0$ | 13.1 | Calculation factor |
|-------|------|--------------------|

**Temperature range**

|            |        |                            |
|------------|--------|----------------------------|
| $T_{\min}$ | -20 °C | Operating temperature min. |
| $T_{\max}$ | 110 °C | Operating temperature max. |